

## Better Products with TGP Test Center



Intelligent solutions for your comfort.

Intelligent solutions for your comfort.

# “ TGP Test Centre runs product tests 24/7 with professionals ”

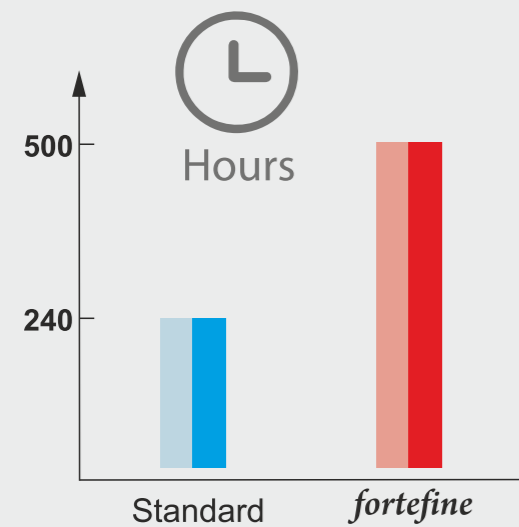

## SALT SPRAY TEST

TGP *fortefine* is our special coating process where we apply zinc coating + special passivation + special finishing. Coating is an indispensable product spec, especially for harsh environments (coastal areas with high humidity and salt content, urban environments with high pollution levels, windy environments with airborne abrasives.) TGP Test Centre utilizes a Salt Spray Test Chamber to run QC on each batch. TGP products have a minimum 500 hours red corrosion life, more than twice the world standard (240 hours) as stated in EN 13126-1, EN 1670 and EN ISO 9227.

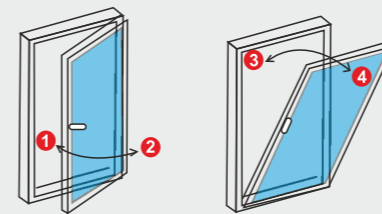

## FATIGUE TEST

We carry out a mechanical cycle test where we run 15.000 complete cycles (open-close-tilt-close) on a TGP Tilt & Turn System at a speed of 250 cycles / hour, which translates into 60.000 movements. (refer to RAL GZ 607/3)

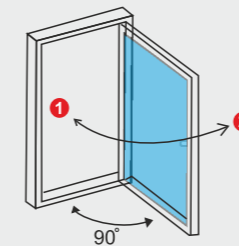

## FATIGUE TEST AT 90°

We carry out a mechanical cycle test where we run 10.000 complete cycles (open-close), sash at 90° on a TGP Tilt & Turn System, at a speed of 250 cycles / hour, which translates into 20.000 movements. (refer to RAL GZ 607/3)

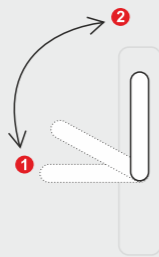
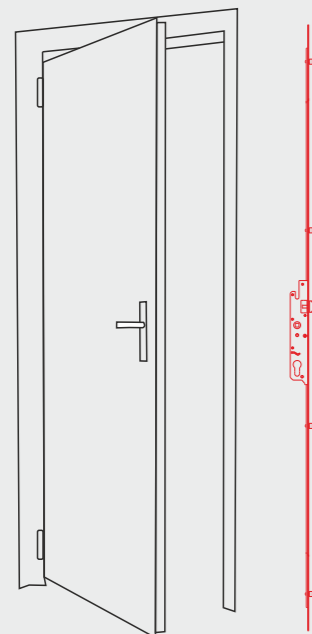

## CYCLE TEST

We carry out a mechanical cycle test where we run 200.000 complete cycles (open-close) on a TGP multipoint door lock at a speed of 250 cycles / hour which translates into 400.000 movements. (refer to EN 13126-4)

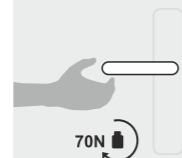

## ENDURANCE TEST

We carry out a mechanical cycle test where we run 25.000 cycles (open-close) on a TGP multipoint door lock at a speed of 250 cycles / hour and apply 70N force. (refer to EN 13126-4)

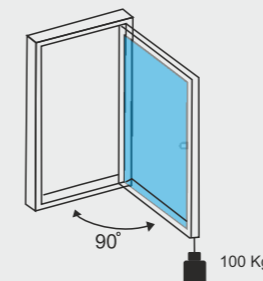

## OVERLOAD TEST

We carry out a mechanical test where we apply a load of 1.000N (100kg), the sash positioned at 90°, for 5 minutes on a TGP Tilt & Turn System.

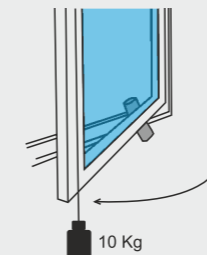

## OBSTACLE TEST

We carry out a mechanical test where we wedge an obstacle between the window and the frame and apply a load of 10kg on a pulley mechanism. We then let the load fall from a height of 200mm and try to slam the window shut. The test is repeated three times. (refer to RAL GZ 607/3)